

- 29 Fit the air duct to the dashboard vent on the driver's side.
- 30 Fit the fuse board.
- 31 Fit the air duct to the floor vent.

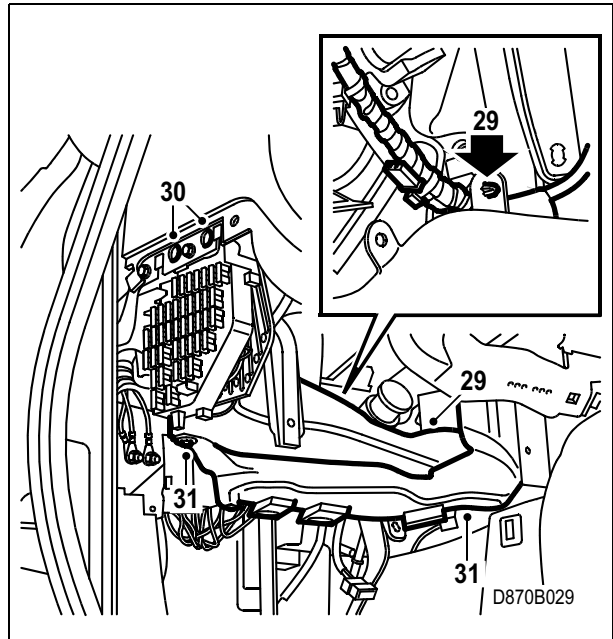

- 32 Fit the knee shield.
- 33 Fit the lower dashboard section.
- 34 Fit the data link connector.
- 35 Clean the control panel.

**Note**

After the procedure is completed, the air distribution control knob may be difficult to maneuver in a horizontal position. This is not abnormal and is due to the heater's basic construction.

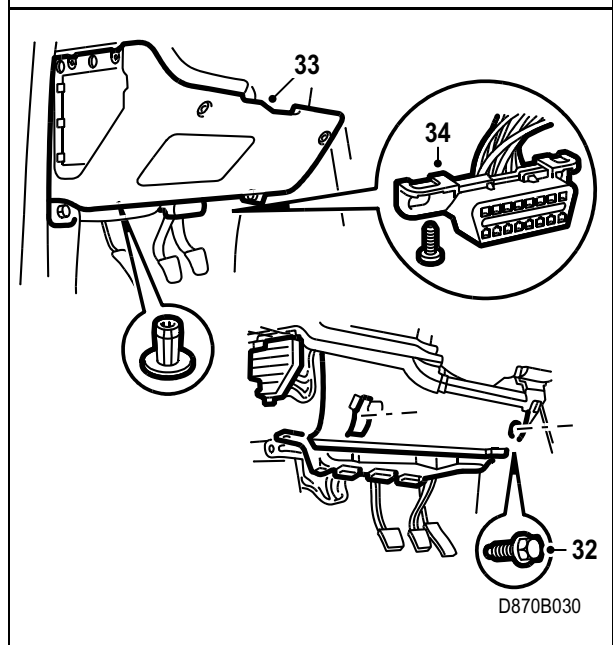

## Replacing temperature control knob and shaft

- 1 Remove the control panel from the rear. Push down the catches using a screwdriver.
- 2 Unplug the connectors from the control panel.
- 3 Remove the clips securing the cable to the control panel by pushing in the catches.
- 4 Unhook the cable eye and lift out the control panel.

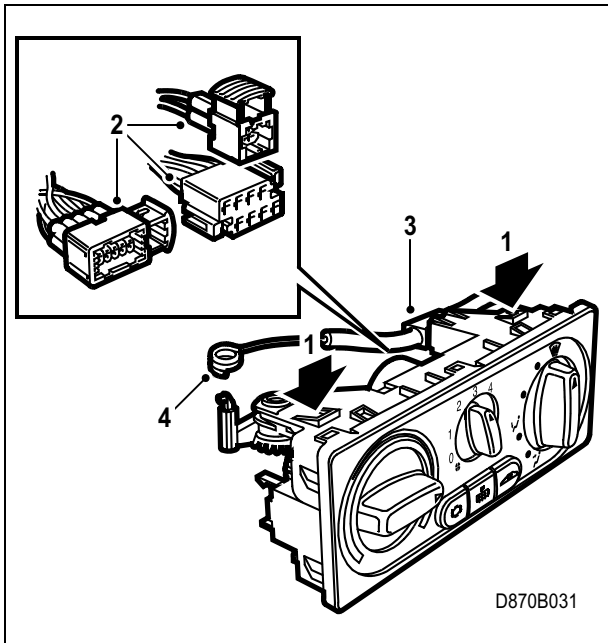

- 5 Turn the temperature control knob to the max. heat setting and push out the knob through the small hole on the back side of the panel with a narrow screwdriver.
- 6 Push the cable attachment lever towards the front of the panel so that the meshed gears holding the spindle shaft are released.
- 7 Pull the lever downwards and out through the hole. Pull out the shaft through the side of the panel.
- 8 Recycle grease from the removed parts to lubricate the shaft and lever. Grease the gear rings and apply a small amount of grease to where the ball will be placed.
- 9 First fit the spring to the shaft followed by the ball.

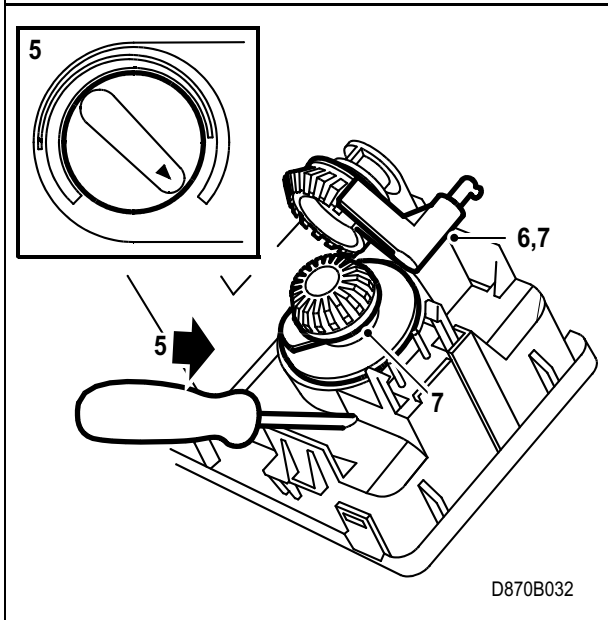

- 10 Insert the shaft into the panel until the ball stops against the panel. Use a narrow screwdriver to depress the ball. At the same time, press in the shaft to snap it into the correct position.

### Important

Do not turn the shaft once it has been snapped into the correct position.

- 11 Fit the lever to the panel.

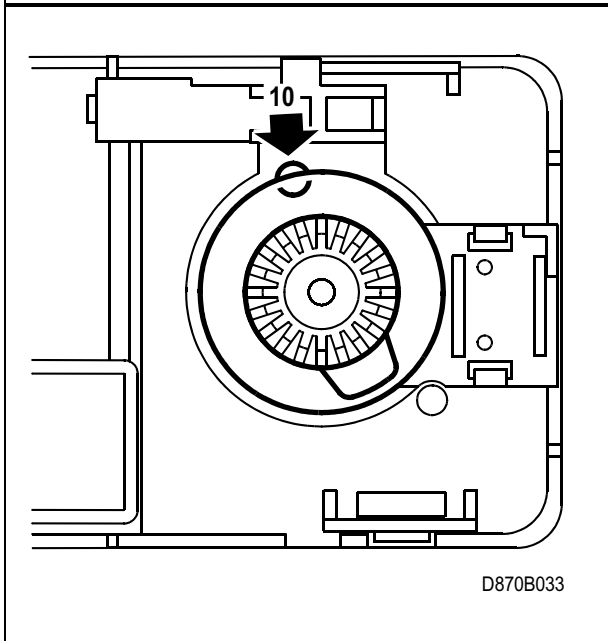

- 12 Turn the lever clockwise (from an overhead perspective) until it snaps into the correct position.
- 13 Fit the temperature control knob.
- 14 Attach the cable to the panel.

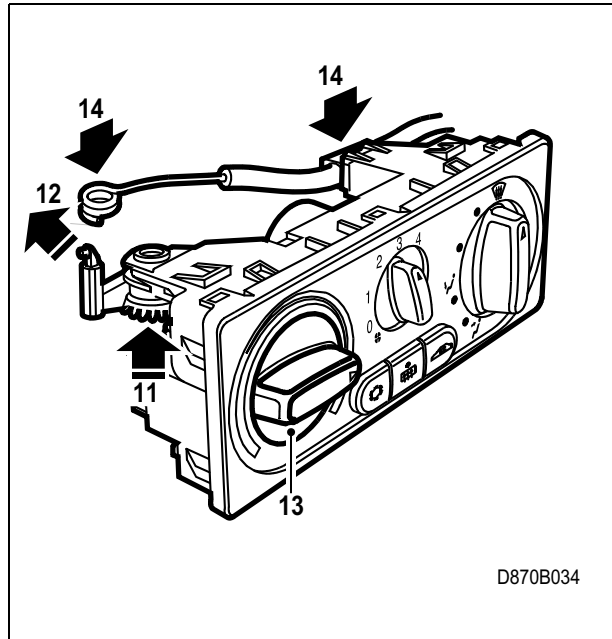

- 15 Check that the gears are in the correct position by turning the knob to the max. heat setting. The cable should run in a straight line from its attachment point, through the centre of the lever hole towards the clip plate.
- 16 Plug in the connectors.

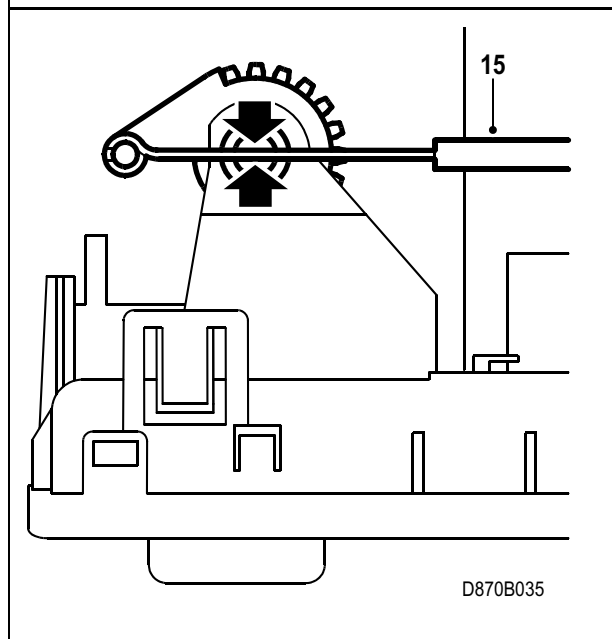

- 17 Fit the control panel and control shaft.

**Important**

Make sure the control shaft is properly pressed into the heating and ventilation unit before fitting to the control panel.

- 18 Return to step 9b under "Procedure".

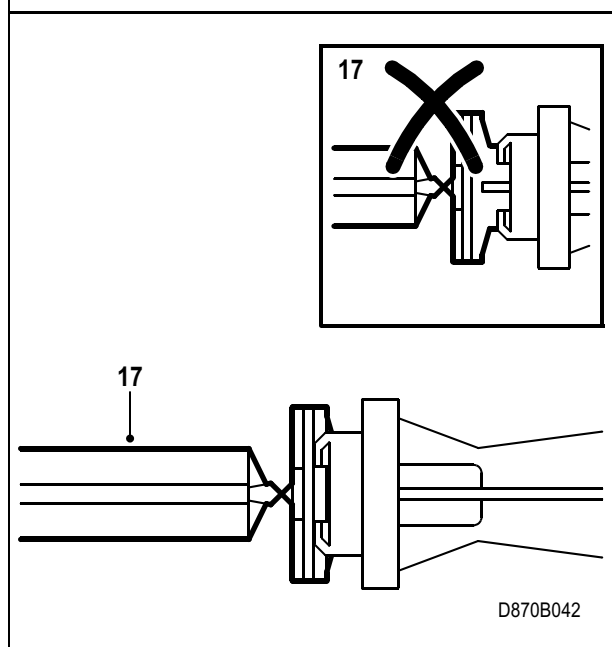

## Replacing the air distribution control knob shaft

- 1 Remove the control panel from the rear. Push down the catches using a screwdriver.
- 2 Unplug the connectors from the control panel.
- 3 Remove the clips securing the cable to the control panel by pushing in the catches.
- 4 Unhook the cable eye and lift out the control panel from the car.
- 5 Remove the air distribution control knob.

### Important

Use adjustable pliers if the knob is difficult to remove. Place a piece of cloth between the pliers and the knob in order to protect the knob from damage.

- 6 Remove the control shaft by
  - a turning it counter-clockwise (seen from the front side of the panel) until the guide pin is in the same position as shown in the illustration.
  - b carefully insert the locking tab using a screwdriver and turn the shaft anti-clockwise until the guide pin is located in the centre of the groove.
  - c carefully pull the control shaft out; retrieve the ball and spring.
- 7 Recycle the grease from the removed shaft and apply it to the new shaft.

- 8 Fit the spring and ball to the new shaft.

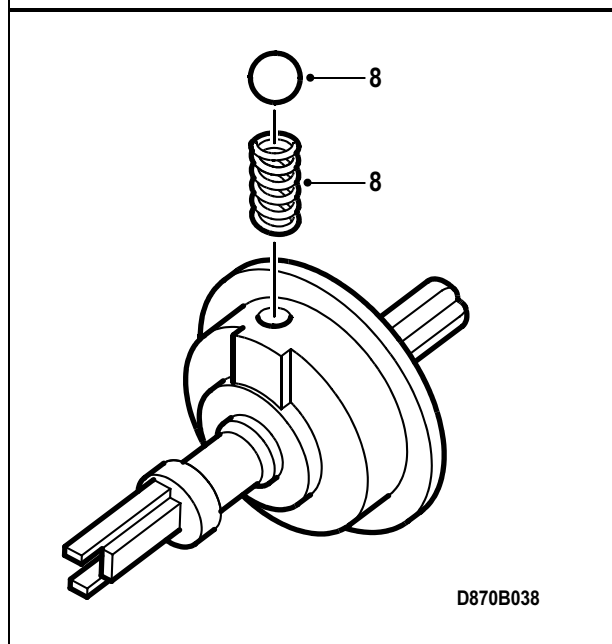
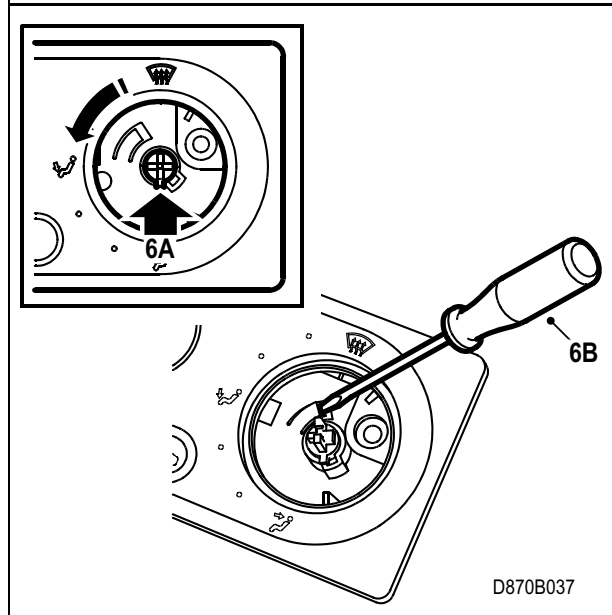
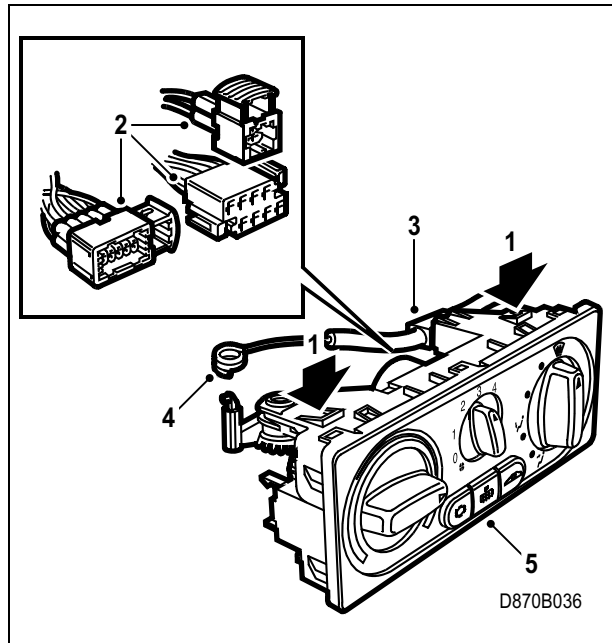

- 9 Insert the shaft to the control panel. Use a screwdriver to hold the ball in place. Turn clockwise from the front side of the panel and make sure the locking tab locks.
- 10 Position the control cable on the back side of the panel. The cable should be positioned above the control shaft.
- 11 Fit the control knob.
- 12 Plug in the connectors.

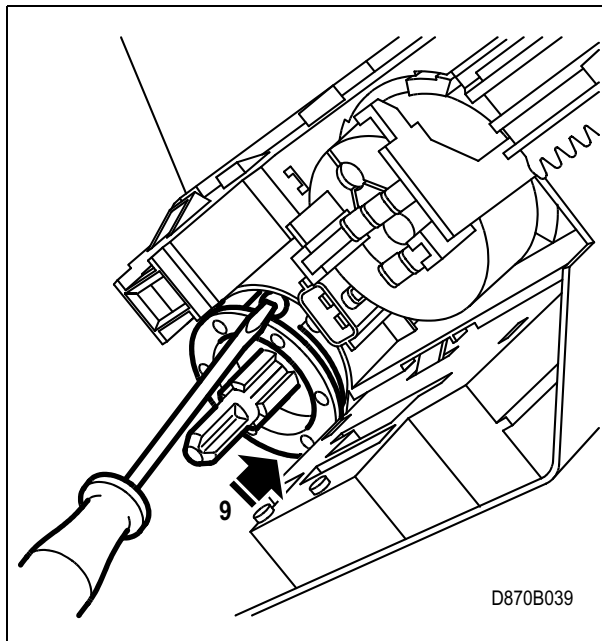

- 13 Position the control panel and fit the telescoping control shaft.

**Important**

Make sure the control shaft is properly pressed into the heating and ventilation unit before fitting to the control panel.

- 14 Test knob function.
- 15 Return to step 9c under "Procedure".

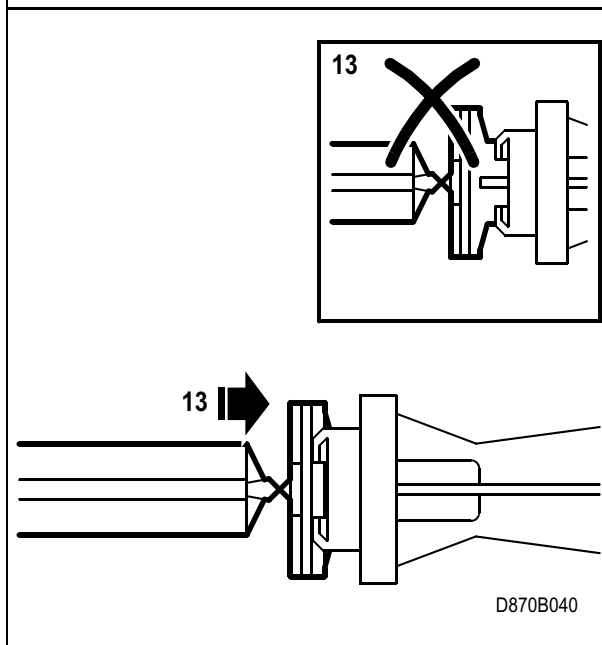

**Time/Warranty information**

Upon customer complaint for a vehicle **under warranty**, use the following information for claims:

- Failed Object: 85453
- Fault/Reason code: 27
- Location code: 09 (US=9)
- Warranty Type (US): 01
- Repair/Action code: 07
- Labour Operation (US): 8545302 (CA: D2507)
- Time: 1.1 hrs.